

Norx[®] Composite Cladding Installation Guide

The **New York** Collection





THE NEXT GENERATION OF COMPOSITE



READ THIS SECTION BEFORE YOU BEGIN!

This installation guide will direct you through the process of installing your **Norx**® product. These installation methods are recommended by **Norx**®, but they may not cover every installation situation you may encounter. Since each installation is unique in its performance requirements, the installation method used is the sole responsibility of the installer. **Norx**® recommends that all designs be reviewed by a licensed architect, engineer, or local building official before installation. Make sure your plans meet federal, state and local building codes before you begin the installation.

SAFETY

Wearing the appropriate safety equipment is necessary when you deal with any type of construction project. **Norx**® strongly suggests wearing the following safety equipment: gloves, a respiratory protection, long sleeves, pants, and safety glasses. This is not a exhaustive list. Other safety equipment may be necessary.

PLANNING AHEAD

To determine how much **Norx**® cladding material you will need, start by calculating the square footage of your wall by multiplying the length by the width. When calculating the amount of cladding you will need, we recommend that you add roughly 10% to the total square footage to account for a scrap factor. The layout for your cladding should be planned out before starting installation to ensure the best results. Building codes and zoning ordinances generally apply to permanent structures, meaning anything that is anchored to the ground or attached to the house may be subject to those regulations. In turn, nearly every kind of cladding project requires permits and inspections from a local building department.

EXPANSION AND CONTRACTION

Norx® cladding planks will experience expansion and contraction with changes in temperature. Expansion and contraction are most significant where extreme temperature changes occur. Changes in length are most likely to occur during the installation process, and should be taken into account if working in extreme temperatures.





THE NEXT GENERATION OF COMPOSITE



READ THIS SECTION BEFORE YOU BEGIN!

ENVIRONMENT

You need a clean, smooth, flat, and strong surface to install **Norx**® products. Make sure your plans meet local building codes before installing any type of cladding.

TOOLS

The tools you need for this installation are listed below:



Cordless drive



Level



Tape Measure



Saw

NOTE

1. The trims we provide are not indispensable. You may use your own trims according to your preferences.
2. Joists must be installed before installing cladding in order to ensure safety.
3. Pre-drill the cladding boards in the exact location where the screws should be affixed using your cordless drive.
4. Screws are required for every connection. We recommend you acquire an ample amount of screws in the event you need more during the installation.





READ THIS SECTION BEFORE YOU BEGIN!

CLIPS



Starter Clip

Code: CLAD-SSS7

Size: 1 1/8" x 1"

(28 x 25mm)

Depth of slot: 9/32" (7mm)

PROFILES



New York Cladding

Model: 

Code: NEW-CLAD

Size: 1" x 6" x 16'

(21mm x 156 mm x 487cm)

Suitable clip: AM02-B-7

TRIM



Norx[®] trim

Model:

Code: TRIM

Size: 2" x 2" x 16'

(50mm x 50mm x 487cm)

SCREW

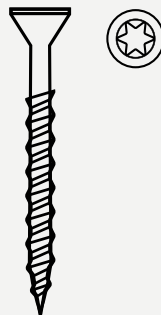

Code: CLAD-SSC1

Note: You can determine your own trim according to your preference.





NOTE: NEW-CLAD shown below.

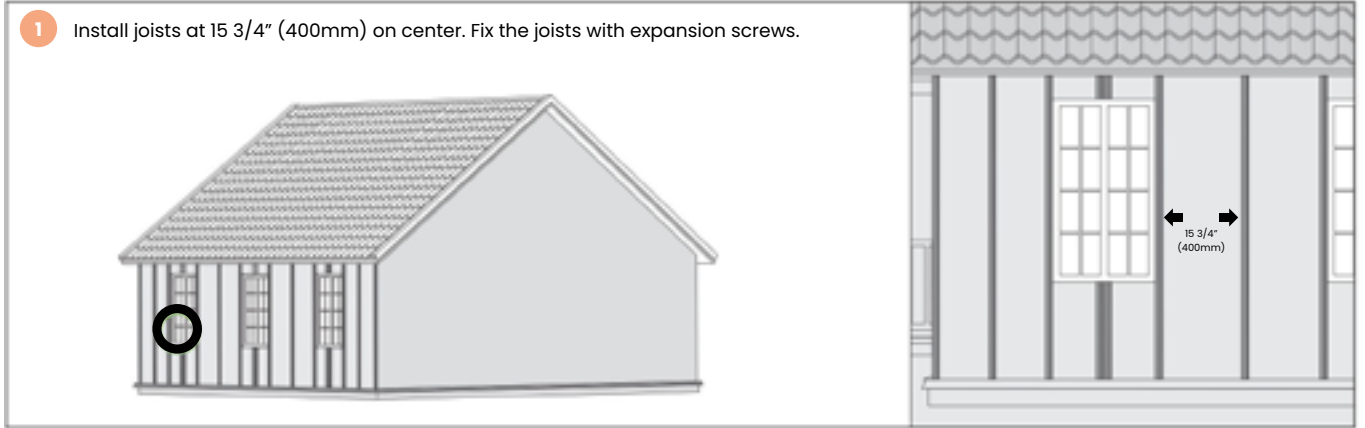

Note

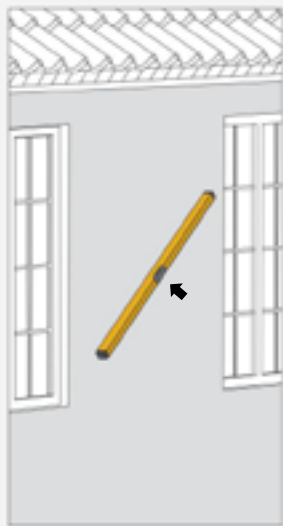

- Make sure the wall is flat. (You can also use a laser level.)

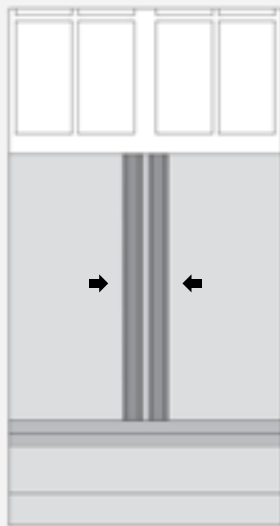

- When installing cladding around a window, you need to use two joists.



- Make sure that there is a joist next to the side of the window. (2" (50mm) is recommended).

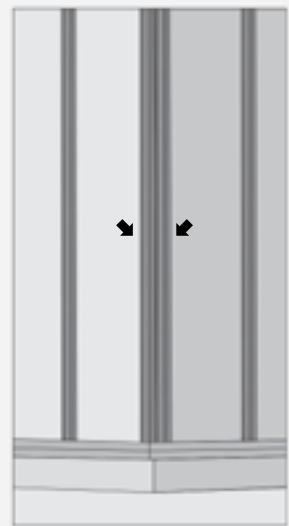

- Double joist for the corner. You can choose wooden joist and aluminum joist.

Note: Before fixing by screws, pre-drill at the exact location for screws with cordless drive.





NOTE: NEW-CLAD shown below.

2 Affix the starter clip to the bottom of every joist.

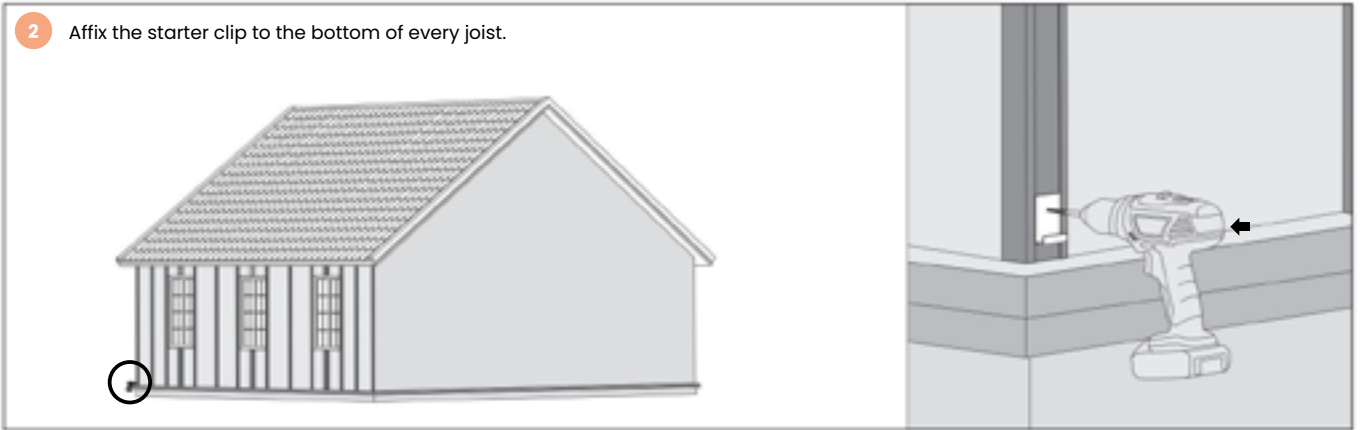

3 Place the first piece of cladding on starter clip.

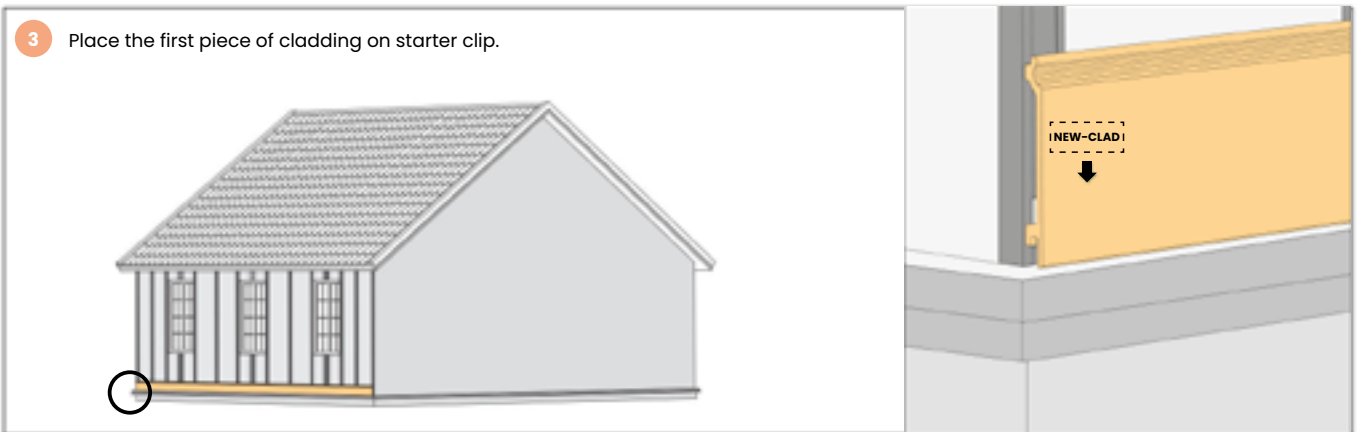

4 Place one screw for per joist at the groove of cladding.

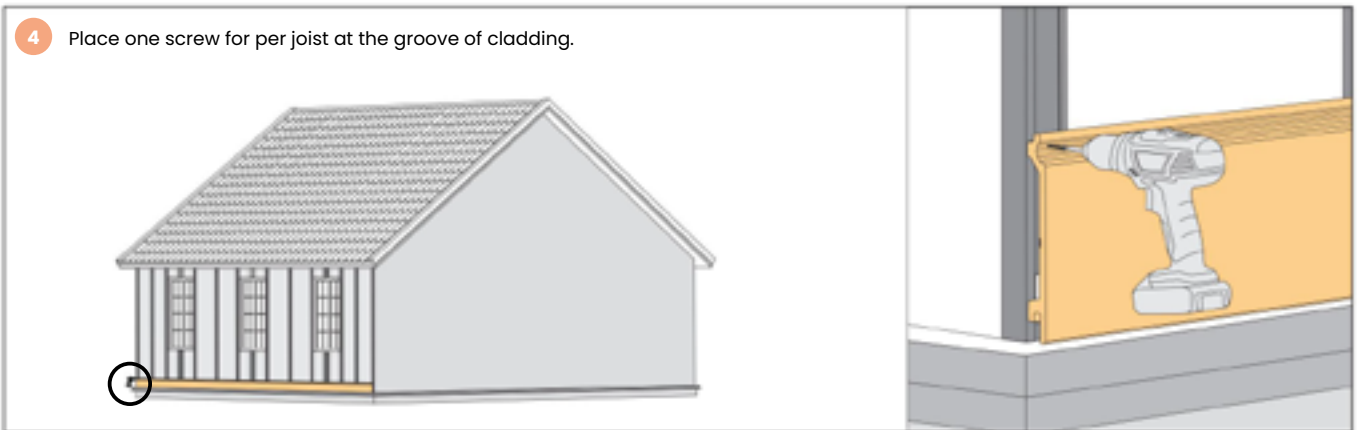



NOTE: NEW-CLAD shown below.

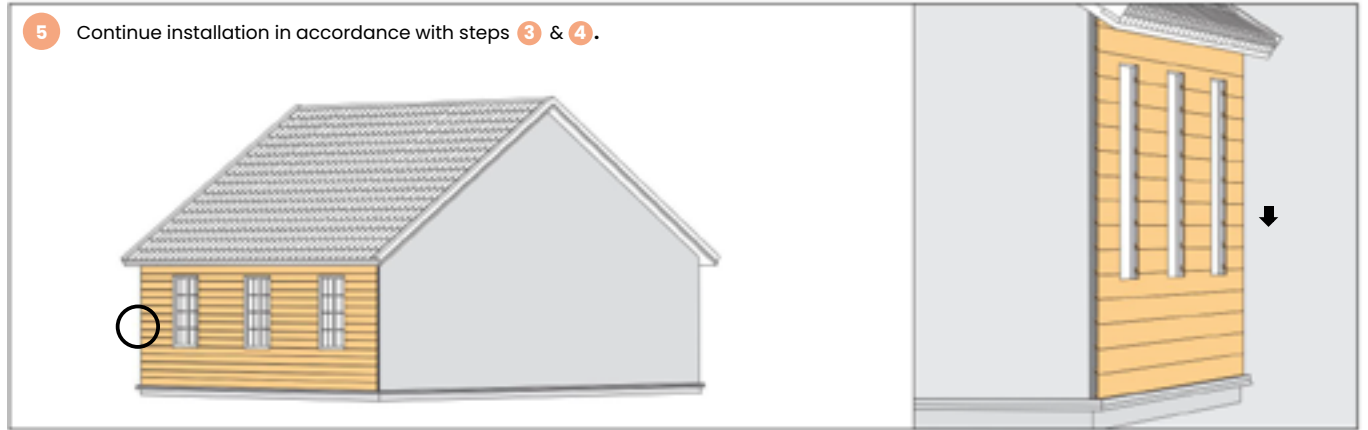

Note

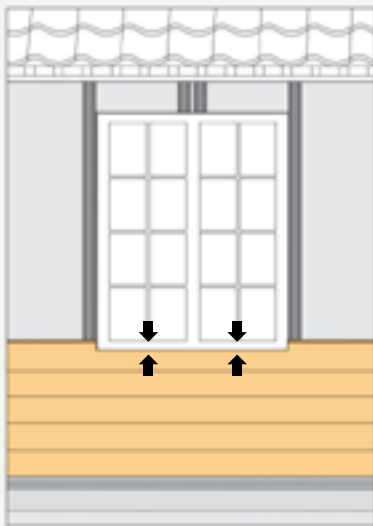

- Cut the cladding in accordance with the size of any existing framing.

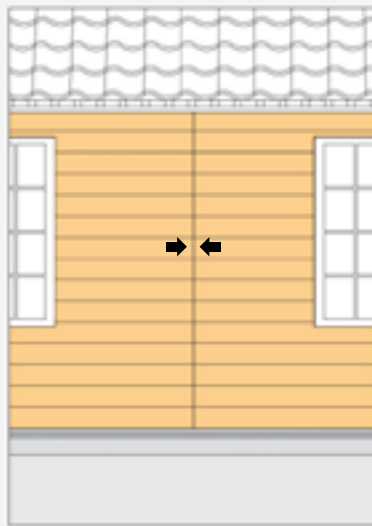

- Leave a gap of at least 1/8" (3mm) between the board junctions.

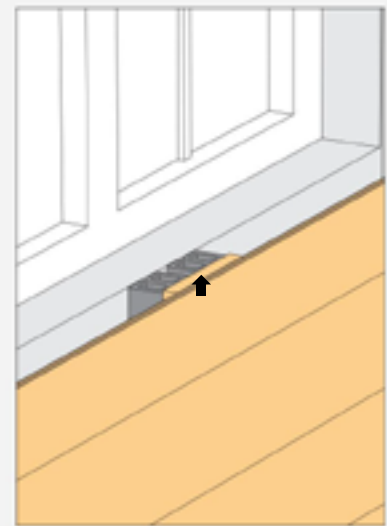

- Put a small piece of wood between the joist and the cladding on the top and bottom of the window.





NOTE: NEW-CLAD shown below.

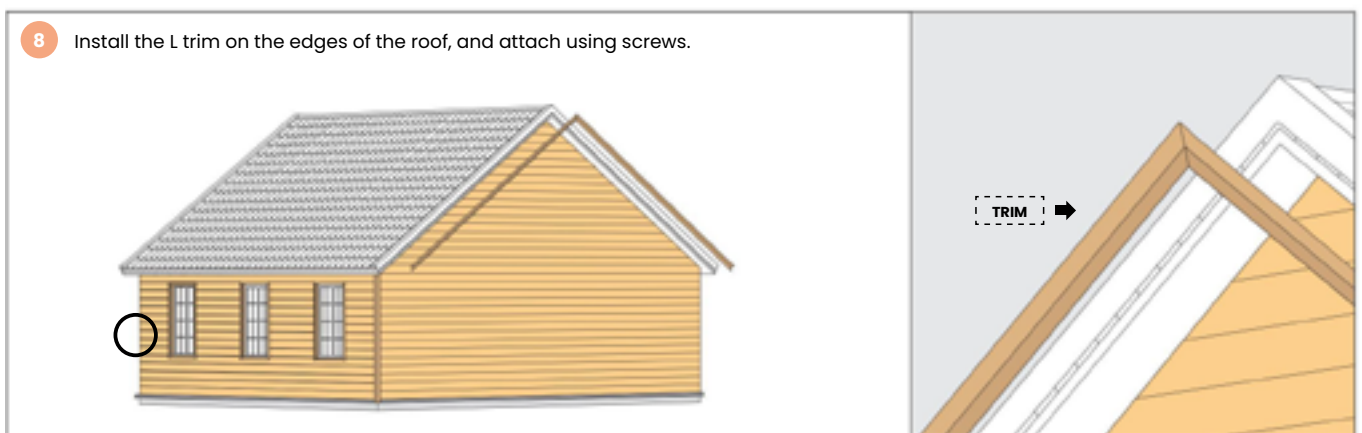
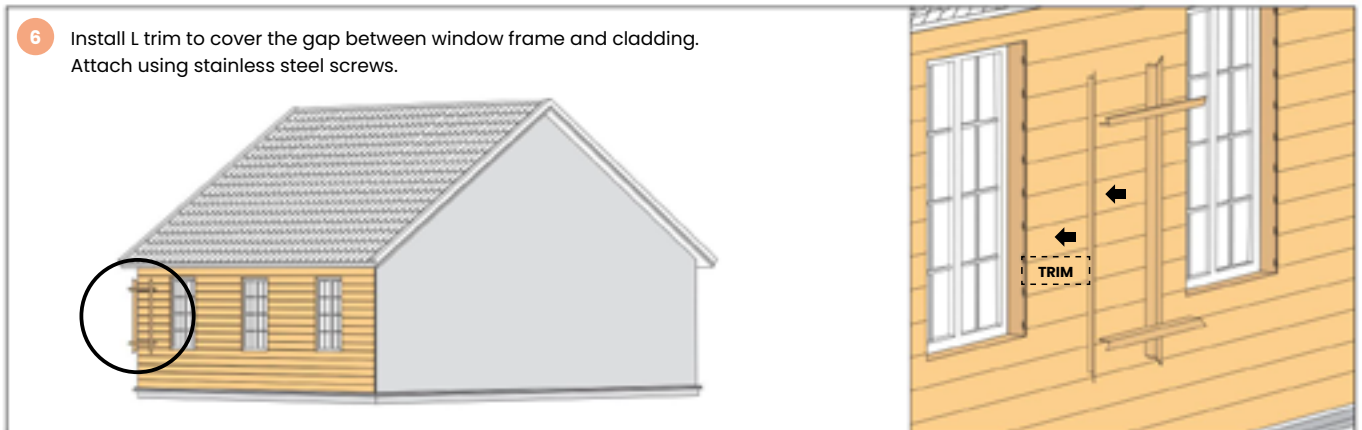



NOTE: NEW-CLAD shown below.



Note

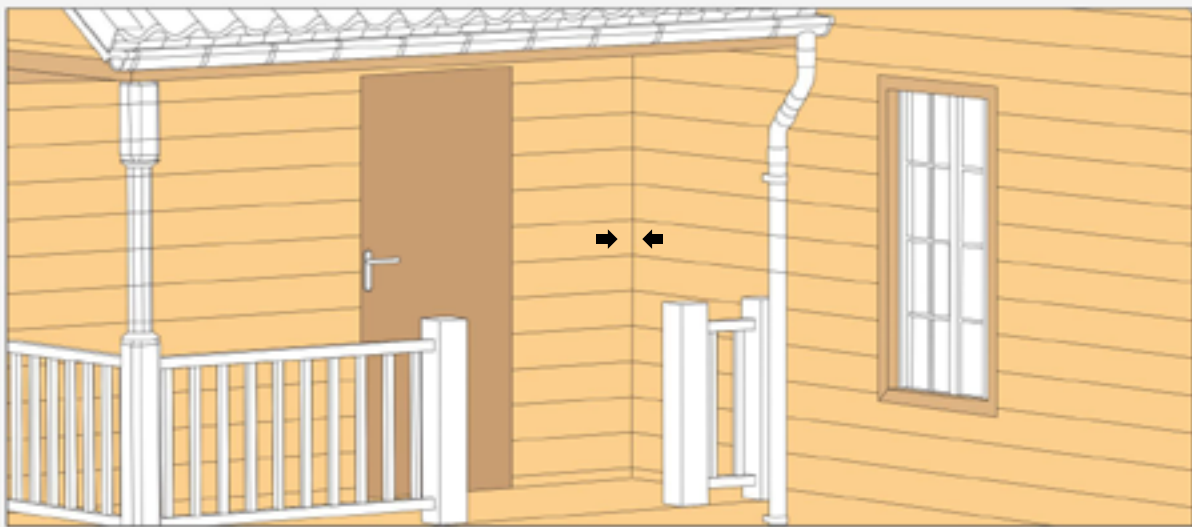

- Installing trim is not necessary for inner corners.

norx[®]

THE NEXT GENERATION OF COMPOSITE

Dive into the
NORX[®] XPERIENCE.
at **NORX.US**

